

AMBER WERCHON

PROPERTY · PEOPLE

SOLD

Site Plan

SCALE 1:200

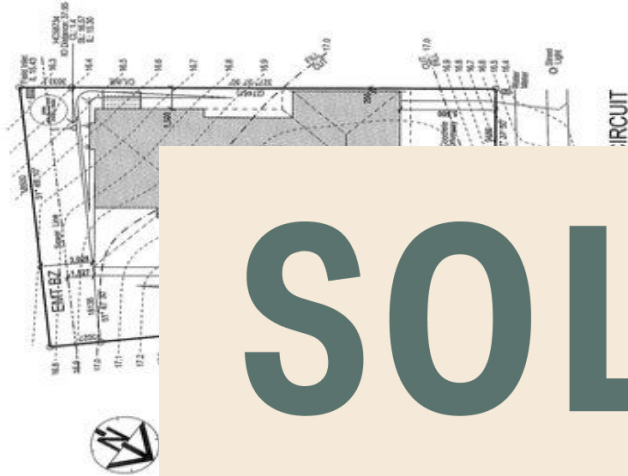

STORMWATER DRAINAGE
 1. 150mm x 100mm stormwater pipes (M10)
 100mm min. cover, 1 in 100 min. fall.
 2. 150mm x 100mm stormwater pipes (M10)
 100mm min. cover, 1 in 100 min. fall.
 3. Stormwater pipes shall be connected to
 Kerbs and Channels by use of a suitable PVC
 manhole.

This is the set of drawings referred to in the Contract
 between P.J. Burns Pty Ltd, Builders and
 K & S Roberts
 For a building to be erected at:
 Lot 4418 Scribbly Gum Circuit, Peregian Springs
 Signed by the Proprietor in the presence of:
 Witness
 Signed by the Builder in the presence of:
 Witness
 Dated the ... day of ... 20...

CONSTRUCTION DRAWINGS	
Date:	15.11.11
Drawn by:	8502
Check by:	AB
Page No:	2
Proposed Residence for K & S Roberts at Lot 4418 Scribbly Gum Circuit, Peregian Springs	
© COPYRIGHT 2011	



41 Scribbly Gum Circuit, PEREGIAN SPRINGS

Full set of plans including elevations + contour plan + it's fully fenced . All is included!!



AWPAMBER
 07 5430 0888
 WERCHONPROPERTY



amberwerchon.com.au