

# AMBER WERCHON

PROPERTY · PEOPLE



## 11 McLean Place Nambour QLD

4 2 3

This well designed family home, presents all shiny and new and offers an amazing lifestyle, particularly for the entertainer; boasting a huge covered timber deck with outdoor kitchen to enjoy weekend BBQ's and celebrations all year around in comfort and style.

Complete with four bedrooms, two bathrooms, separate living and dining, well equipped kitchen, north facing alfresco deck, triple lock up garage plus additional on-site space to park boat/trailer or extra vehicles with a large 8x4 workshop.

The property is on a landscaped 840m2 block with a fenced backyard; this is a generous sized home inside and out, and facilitates easy care family living of a high calibre.

[For full version visit the website](https://www.amberwerchon.com.au)

**Type** : House  
**Price** : \$460,000  
**Land Size** : 840 sqm  
**View** : <https://www.amberwerchon.com.au/sale/qld/sunshine-coast/nambour/residential/house/2881177>



**Amber Werchon**  
07 5430 0888

<https://www.amberwerchon.com.au>

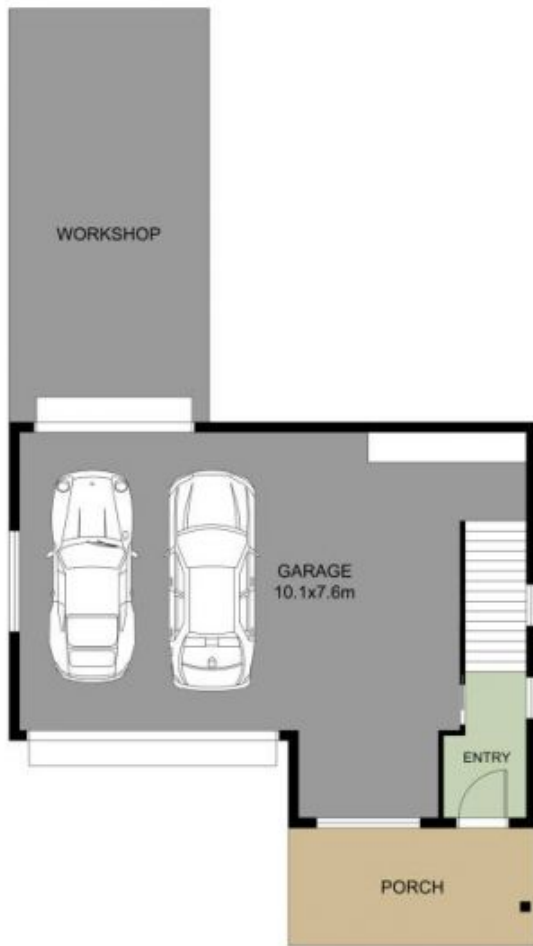

DOWNSTAIRS



UPSTAIRS