



AMBER WERCHON

PROPERTY · PEOPLE



77 Marawa Drive Parrearra QLD

5  3  2 

This brand new, modern day family home offers style, functionality, quality, convenience and comfort. Built to blue ribbon standards and boasting an outstanding floor plan over two levels. Cleverly situated on the 601m² block allowing a spacious lawn area for the kids to enjoy our perfect Sunshine Coast lifestyle.

Downstairs features family and kitchen zone, media room or office, bedroom, bathroom, excellent storage and separate laundry. Upstairs features master bedroom, ensuite, three bedrooms, bathroom, media or kids play area and computer nook.

The front door opens to the wide tiled hallway and leads to the open plan living, dining and kitchen area. Featuring

[For full version visit the website](https://www.amberwerchon.com.au/sale/qld/sunshine-coast/parrearra/residential/house/4376812)

Type : House
Price : \$760,000
Land Size : 601 sqm
View : <https://www.amberwerchon.com.au/sale/qld/sunshine-coast/parrearra/residential/house/4376812>



Amber Werchon
07 5430 0888

<https://www.amberwerchon.com.au>

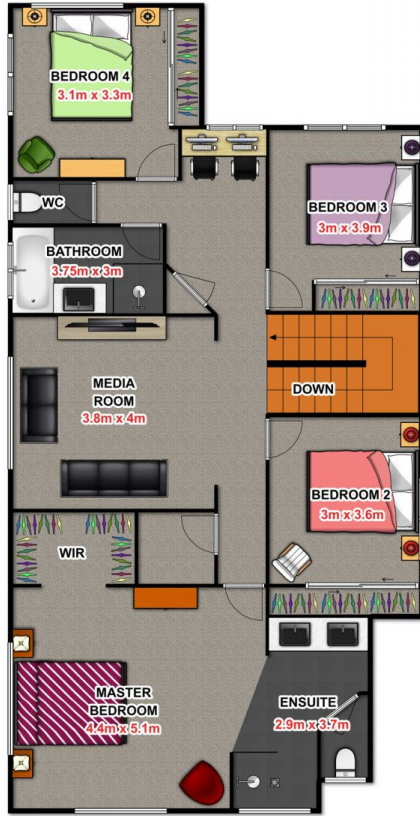

Upper Level



Lower Level

ARTIST ILLUSTRATION

THIS FLOOR PLAN IS CONCEPTUAL ONLY. IT IS PROVIDED FOR ILLUSTRATIVE PURPOSES AND SHOULD NOT BE RELIED UPON. WE MAKE NO GUARANTEE AS TO THE ACCURACY OF THIS PLAN. ALL INTERESTED PARTIES SHOULD MAKE AND RELY ON THEIR OWN ENQUIRIES IN DETERMINING THE ACCURACY AND INFORMATION CONTAINED ON THIS FLOOR PLAN.