

# AMBER WERCHON

PROPERTY · PEOPLE



## 1 Ellem Court Kiels Mountain QLD

5 3 6

Amber Werchon Property presents to the market 1 Ellem Court, Kiels Mountain.

"gundu" is a super-sized family home with self-contained dual living under, on a parklike 7942m2 block in a dress circle acreage pocket, offers versatile options, in a picturesque and private setting. The owner is downsizing and there is enough room here for the Brady Bunch!

The home is double storey, set back from the road, and is complete with five bedrooms, three bathrooms, three separate living areas, kitchen and kitchenette, covered rear deck with delightful outlook over property, two laundries, double lock-up garage and double carport. The downstairs level is fully self-contained and has both external and internal access - so could suit extended family or third-party

[For full version visit the website](https://www.amberwerchon.com.au)

**Type** : House  
**Price** : Contact Agent  
**Land Size** : 7942 sqm  
**View** : <https://www.amberwerchon.com.au/sale/qld/sunshine-coast/kiels-mountain/residential/house/4594987>



**Amber Werchon**  
07 5430 0888

<https://www.amberwerchon.com.au>

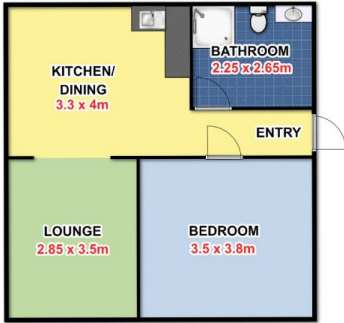

Granny Flat

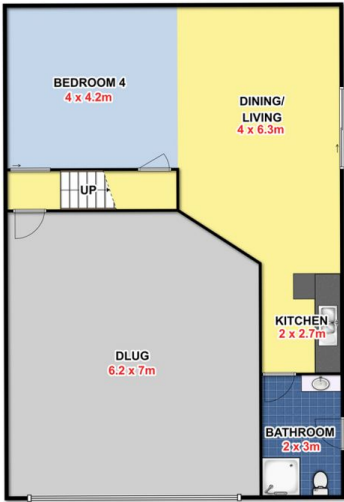

Lower Level



Upper Level

**ARTIST ILLUSTRATION**

THIS FLOOR PLAN IS CONCEPTUAL ONLY. IT IS PROVIDED FOR ILLUSTRATIVE PURPOSES AND SHOULD NOT BE RELIED UPON. WE MAKE NO GUARANTEE AS TO THE ACCURACY OF THIS PLAN. ALL INTERESTED PARTIES SHOULD MAKE AND RELY ON THEIR OWN ENQUIRIES IN DETERMINING THE ACCURACY AND INFORMATION CONTAINED ON THIS FLOOR PLAN.

\*Not to scale



Site Plan

\*Not to scale

**ARTIST ILLUSTRATION**

THIS FLOOR PLAN IS CONCEPTUAL ONLY. IT IS PROVIDED FOR ILLUSTRATIVE PURPOSES AND SHOULD NOT BE RELIED UPON. WE MAKE NO GUARANTEE AS TO THE ACCURACY OF THIS PLAN. ALL INTERESTED PARTIES SHOULD MAKE AND RELY ON THEIR OWN ENQUIRIES IN DETERMINING THE ACCURACY AND INFORMATION CONTAINED ON THIS FLOOR PLAN.