

AMBER WERCHON

PROPERTY · PEOPLE



15 St Lucia Crescent Kawana Island QLD

5  3  3 

From the moment you step inside the grand entrance of this magnificently built home, the tone is set for comfortable, luxurious and stylish living.

This 5 bedroom home is designed to suit a bustling family life, or the entertainers dream, absolutely no expense has been spared. Boasting top of the range construction this home is located on the biggest block in Kawana Island!

No stone left unturned in its design and execution, on a staggering 1030m² block boasting a 20metre northeast facing water frontage and over 650 sqm under roof. Reflection ponds, water features and creatively crafted wood bridges navigate the home and entry, combined with low maintenance landscaping giving you that sensational tropical feel. Wide decks flow from the heated pool and spa to surround the home and entertainment areas, this

Type : House
Price : \$3,000,000
Building Size : 650 sqm
Land Size : 1030 sqm
View : <https://www.amberwerchon.com.au/6697776>



Terri-Anne Murray
07 5430 0888



Amber Werchon
07 5430 0888

[For full version visit the website](https://www.amberwerchon.com.au)

<https://www.amberwerchon.com.au>

15 St Lucia Crescent, Parrearra



Upper Level

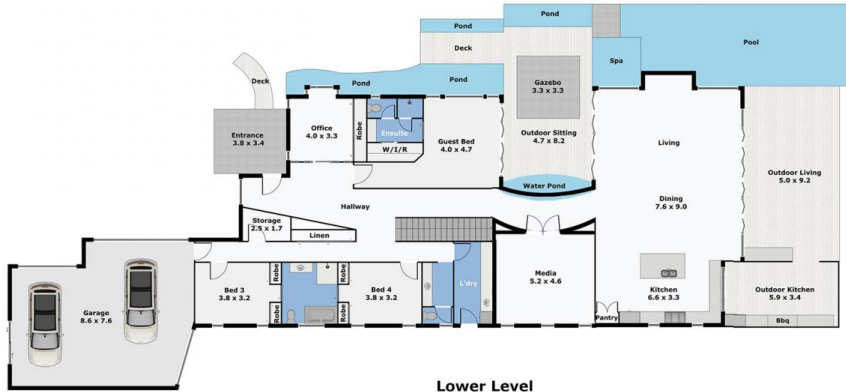

Lower Level

Area	
Interior	472 m ²
Exterior	136 m ²
Total	608 m²

This floor plan illustration is an approximation of existing structures and features and is provided for convenience only with the permission of the seller. All measurements and m2 are approximate and not guaranteed to be exact or to scale. Buyer should confirm measurements using their own source. Bedrooms are measured from wall to robe.