

AMBER WERCHON

PROPERTY · PEOPLE



34-38 Price Street Nambour QLD

Rudi du Preez from Amber Werchon Property and Emily Pendleton from Ray White Commercial Northern Corridor Group are pleased to present 34-38 Price Street, Nambour to market for sale.

Positioned in the heart of Nambour, the property offers excellent access across the Sunshine Coast and a rare opportunity to secure a freehold building within close proximity to the Nambour CBD. With a total land area of 2,570m² and a total building area of approximately 878m² over two levels, the property suits both owner-occupiers and investors, with immediate occupancy available or the option to work with the agents to secure long-term leases.

The property benefits from short-term, flexible leases

[For full version visit the website](https://www.amberwerchon.com.au)

Type	: Retail
Price	: Expressions of Interest
Building Size	: 833 sqm
Land Size	: 2570 sqm
View	: https://www.amberwerchon.com.au/sale/qld/sunshine-coast/nambour/commercial/retail/8622434



Rudi du Preez
0417 774 047

<https://www.amberwerchon.com.au>

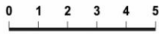
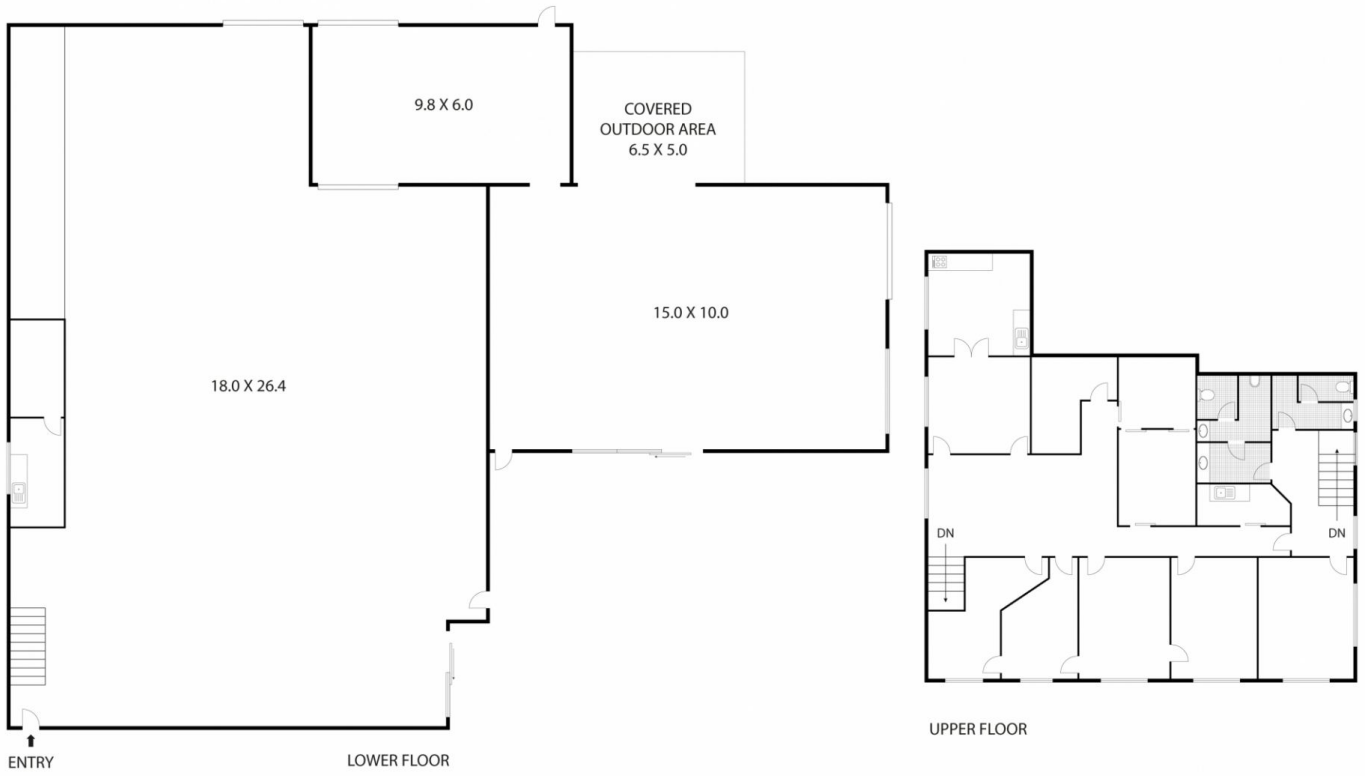

Scale in metres. Indicative only. Dimensions are approximate. All information contained herein is gathered from sources we believe to be reliable. However we cannot guarantee its accuracy and interested parties should rely on their own enquiries.

Lower Floor	-	638.1 m ²
Upper Floor	-	208.0 m ²
External	-	32.5 m ²
Total	-	878.6 m²



34-38 Price Street, Nambour